



Canal &  
River Trust

National  
Waterways  
Museum  
Gloucester

## Museum Map

### River Severn from the air

Filmed from the air this beautiful film shows local landmarks and scenic views of the River Severn on a lovely summer's day.

### Family Wildlife Trail

Wildlife is an ever present feature of the canals, whether it's the birds and butterflies we see today or the mice and rats that called the grain warehouses home. Follow our family trail around the museum and meet some of the animals you might see out on the canal.



[canalrivertrust.org.uk/gloucester](http://canalrivertrust.org.uk/gloucester)

### Boat trips and the Quayside

Ask at the Welcome Desk about our 45-minute boat trips along the Gloucester and Sharpness Canal on Queen Boadicea II, a Dunkirk Little Ship.

The boat leaves from the quayside where you can find historic cranes and boats and also get a great view of the warehouses of the Gloucester Docks. Sabrina 5, one of the largest boats in our collection, is permanently moored on the quayside and doubles up as a fully accessible education and exhibition space.

### Access at the Museum

The National Waterways Museum, Gloucester is housed in an old warehouse with uneven and worn flooring. The quayside is a working area and may be uneven and slippery in wet or icy weather.

The main museum warehouse is fully accessible for wheelchair users. Queen Boadicea II's gangplank is too narrow for most electric wheelchairs, so she's only accessible for manual wheelchairs. Please ask a member of our team if you need any help.

Keep in touch with developments, events and activities at the museum via our website [canalrivertrust.org.uk/gloucester](http://canalrivertrust.org.uk/gloucester) or on social media below.

 NationalWaterwaysMuseumGloucester

 @gloswaterways

 @nwmuseumgloucester



At Canal & River Trust, we believe that spending time by water makes us healthier and happier. We are the charity that cares for and brings to life 2,000 miles of waterways across England and Wales.

Find out how, with our partners and volunteers, we are making life better by water

[canalrivertrust.org.uk](http://canalrivertrust.org.uk)

Charity No. 1146792



# Welcome

Set in the landmark Grade II Victorian grain warehouse you will find our stories of the River Severn, Gloucester Docks and the canals connected to them.

Discover how the waterways are at the heart of the life of Gloucester and how they shaped the lives of those who travelled, repaired and used them. Families can explore the galleries and discover fun facts and activities on the bright yellow exhibition panels.

## The Severn Trow

The centrepiece is a 6m rope recreation of a Severn Trow – unique to the area. The trow's flat bottom design allowed it to sail through the shallow sections of the river.

## Dock model

Take yourself back to the heyday of Gloucester Docks. Immerse yourself in the sounds and images of a bustling, multicultural workplace at the heart of the regional transport network.



First Floor

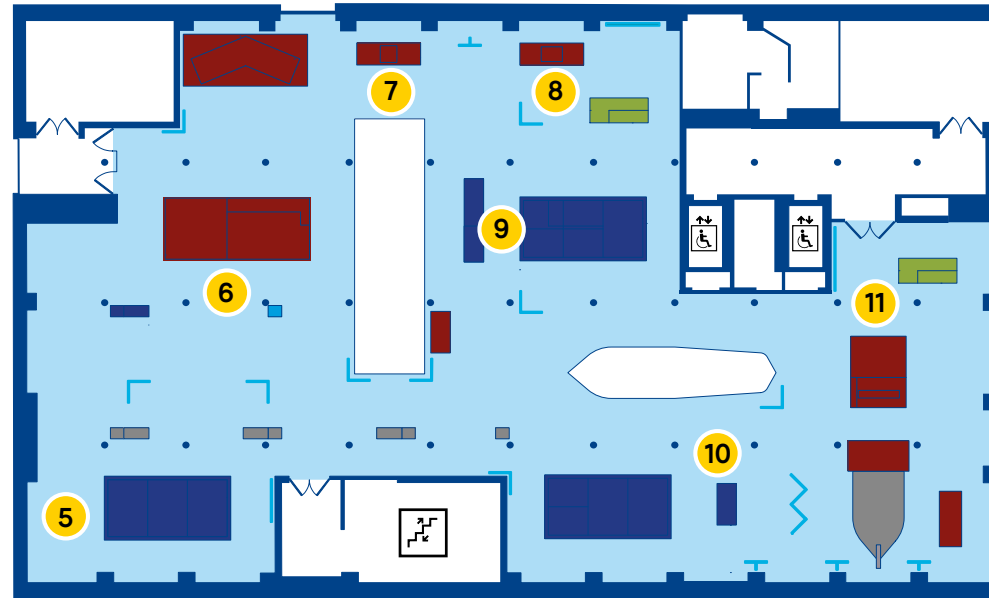

Ground Floor

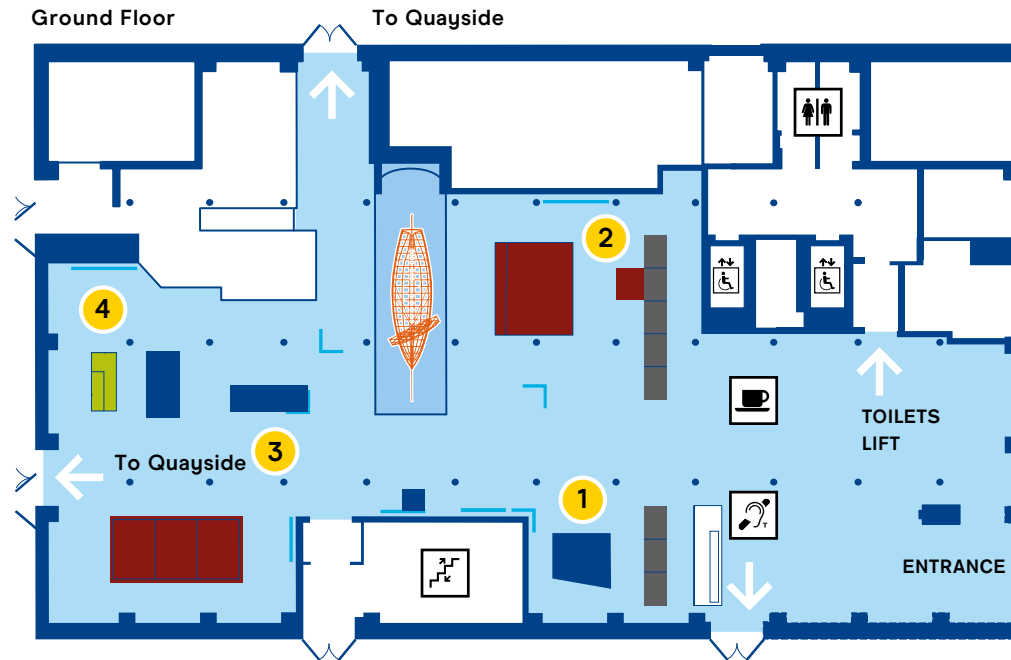

## Key

- The River Severn.** Learn more about the story of the people and boats that worked on Britain's longest river.
- Gloucester Docks.** See what it was like to work in the UK's largest inland port.
- Horse Power.** Discover how boats were pulled by men or horses and then powered by engines.
- Boat Building and Repair.** Find out how boats were first built from wood and then metal.
- The Gloucester & Sharpness Canal.** Once the largest canal in England, but why was it built and what impact did it have on the port of Gloucester?
- Canal Maintenance.** Discover how canals were kept open by dredging, repair work and how divers were involved.
- The Severn and Canal Carrying Company and the Cadbury Family.** Find out how the chocolate makers used boats to transport their goods along the waterways.
- Waterways at War.** Understand the vital role Gloucester Docks and the River Severn played during World War Two.
- Canal Management.** Who managed and policed the canals, how was water supplied and how were tolls measured?
- Going Up Country.** See how narrowboats took goods from Gloucester Docks into the industrial Midlands.
- Leisure.** As trade on the canals declined, see how this was replaced by people using them for leisure.

- |              |                |
|--------------|----------------|
| Stairs       | Access lift    |
| Toilets      | Learning table |
| Hearing loop | Tearoom        |